

Applying
CBT in
Diverse
Contexts

51ST ANNUAL CONVENTION

November 16–19, 2017 | Hilton San Diego Bayfront

Program Grids & Floor Plans

Program Grids

Friday Grid — **4–9**

Saturday Grid — **10–15**

Sunday Grid — **16–17**

Floor Plans

Level 1 | Promenade Level — **19**

Level 2 | Indigo Level — **20**

Level 3 | Aqua Level — **21**

Level 4 | Sapphire Level — **22**

Level 5 | Cobalt Level — **23**

Meeting Room	Time	8 a.m.				9 a.m.				10 a.m.				11 a.m.				12 p.m.				1 p.m.				2 p.m.				3 p.m.				4 p.m.				5 p.m.				6 p.m.		
		:00	:15	:30	:45	:00	:15	:30	:45	:00	:15	:30	:45	:00	:15	:30	:45	:00	:15	:30	:45	:00	:15	:30	:45	:00	:15	:30	:45	:00	:15	:30	:45	:00	:15	:30	:45	:00	:15	:30				
Level 2 - Indigo Level																																												
Indigo 202		MCS 1: Harnessing the Power of Brief Behavioral Interventions: Seven Principles for Success (42)								Become Board Certified in CBT: Join the Crowd (65)																MCS 4: Alliance-Focused Training for CBT: Strategies for Identifying, Addressing, and Repairing Ruptures in the Therapeutic Alliance in CBT (111)								MCS 5: Collecting Progress Monitoring Data To Guide Treatment and Contribute to Research (137)										
Indigo 204		MCS 2: CBT for Difficult-to-Treat Depressed Patients (43)																Annual Meeting of the Members (90)								WK 5: Practical Skills for Practicing in Integrated Primary Care Settings (115)																		
Indigo 206		Women's Issues in Behavior Therapy SIG (60 min) (22)				Autism Spectrum and Developmental Disorders SIG (48)				Anxiety Disorders SIG (71)				Child and Adolescent Anxiety SIG (95)				Spiritual and Religious Issues SIG (118)				Cognitive Therapy SIG (141)																						
Indigo A		PD 3: Moving Beyond Silos: Translational Collaborations to Further Integration and Exploration of Neural Mechanisms Across Diverse Treatment Contexts (22)								SYM 12: Promotion of Evidence-Based Treatments for Youth Through State and Local Policy Initiatives: Implications for Dissemination and Implementation Science (48)								SYM 23: The Real-World Impact of Borderline Personality Symptoms on Interpersonal Functioning and Maladaptive Emotion Regulation (72)								SPOTLIGHT RESEARCH: The Latest in Transdiagnostic Treatment: Findings from a Large-Scale Clinical Trial Comparing the Unified Protocol to Single-Diagnosis Protocols (94)				SYM 49: A tailored implementation of CBT in a Youth Residential Setting (113)				SYM 60: Implementation of EBPs for Serious Mental Illness on Assertive Community Treatment Teams in Diverse Community Mental Health Systems (138)										
Indigo B		SYM 1: Role of Coercive Control in Diverse Intimate Relationships (23)								PD 4: Neural Network Models: Relevance for the Present and Future of CBT (47)				PD 7: Treating Military Servicemembers, Military Veterans, and Their Families in the Private Sector: A Consortium of New York Hospitals (68)				SYM 36: Advancing the Pragmatic Measures Construct and Three New Measures of Implementation Outcomes (91)				SYM 48: Improving the Dissemination of Evidence-based Early Interventions through Technology (112)				SYM 59: Prevention of Depressive Disorders Among "At risk" Adolescents (136)																		
Indigo CDGH	Exhibits & Poster Sessions																	Exhibits & Poster Sessions																										
	Poster Session 1 8:30 - 9:30				Poster Session 2 9:45 - 10:45				Poster Session 3 11:00 - 12:00				Poster Session 4 12:15 - 1:15				Poster Session 5 1:30 - 2:30				Poster Session 6 2:45 - 3:45				Poster Session 7 4:00 - 5:00																			
	1A - Addictive Bx Comorbidity- Substance Use and Other (307)				2A - Adult Anxiety (317)				3A - ADHD- Child ADHD- Adult (327)				4A - CBT Tx (338)				5A - Suicide and Self Injury Military and Veterans Psychology (349)				6A - Transdiagnostic (360)				7A - PTSD Child/ Adolescent Trauma/ Maltreatment (371)																			
	1B - OCD Tic + Impulse Control Disorders (310)				2B - Eating Disorders Obesity/ Overweight (320)				3B - Adult Depression Bipolar Disorder (331)				4B - Suicide and Self Injury (342)				5B - Health Psychology- Adult Health Care/ Public Policy Primary Care (353)				6B - ADHD- Child ASD and Developmental Disorders (364)				7B - Addictive Bx (375)																			
	1C - Eating Disorders (314)				2C - Adult Depression/ Dysthymia Child/ Adolescent Depression (324)				3C - Comorbidity- Other Tx- Other Sleep/ Wake Disorders (334)				4C - Anger Violence/ Aggression (345)				5C - Cultural Diversity/ Vulnerable Populations LGBT (357)				6C - Assessment Dissemination/ Implementation (367)				7C - Dissemination/ Implementation (378)																			
Indigo E	SYM 2: Recent Innovations in Mobile Health Interventions for Depression: From Internet-delivered Behavior Activation to Serious Games and Cognitive (Re)training (24)								SYM 13: Adolescents and Young Adults with ADHD: Challenges and Transitions (49)								SYM 24: Novel Interventions for Smoking Cessation (73)								SYM 37: From Resilience to Risk to Prevention: Immigrant Status and the Duration of Untreated Psychosis in US Latinos with First Episode Psychosis (96)				Research Facilitation Committee Session: The Virtual Research Lab: Discussing the Unique Opportunities and Challenges Experienced in Conducting Web-Based Research (122)															
Level 3 - Aqua Level																																												
Aqua (Salon) AB	Internship Training Site Overview (28)								Intern Meet & Greet (46)								Postdoctoral Paths for Professional Development (67)								PD 8: Cultivating Cultural Flexibility: Incorporating Contextual, Sociopolitical, and Culture-based Cues in Mindfulness and Acceptance-based Therapies (92)								Graduate School in Psychology and Social Work: Getting In and Making It Work (140)											

() = Page for Listing in Conference Book
CGR = Clinical Grand Rounds
CRT = Clinical Round Table
MCS = Master Clinician Seminar

MPD = Membership Panel Discussion
PD = Panel Discussions
RPD = Research and Professional Development
S = Symposia

SIG = Special Interest Group
WK = Workshop
MWK = Mini Workshop
1A, 2A, etc... = Poster Sessions

Meeting Room	Time	8 a.m.				9 a.m.				10 a.m.				11 a.m.				12 p.m.				1 p.m.				2 p.m.				3 p.m.				4 p.m.				5 p.m.				6 p.m.		
		:00	:15	:30	:45	:00	:15	:30	:45	:00	:15	:30	:45	:00	:15	:30	:45	:00	:15	:30	:45	:00	:15	:30	:45	:00	:15	:30	:45	:00	:15	:30	:45	:00	:15	:30	:45	:00	:15	:30				
Aqua (Salon) C & D				SYM 4: Boosting CBT Efficacy with Pre-Session Memory Enhancers: The Current State of the Art (29)					PD 5: Charting Clinical Psychology Careers in Behavioral Medicine Settings (53)					SYM 26: "Late Onset" ADHD: What It Is, What It Is Not, and Why It Matters (76)					PD 9: You Will Get Better and You Won't: Using Brain Imaging and Biomarkers to Predict Treatment Response (99)					PD 10: Towards More Effective Interventions in Mental Health: Discussion of Work by the Netherlands Institute for Advanced Studies 2017 Depression Theme Group (119)										Awards Ceremony (143)										
Aqua (Salon) E & F				PD 2: New Grounds to Promote CBT in Diverse Contexts: Implications of clinical Practice Guidelines for Clinical Training, Practice, Research, and Policy (30)					SYM 15: Applying Advanced Structural Equation Modeling (SEM) to Understand and Disseminate Substance Use Data in Diverse Contexts (54)					SYM 27: Innovative Ways to Involve Families in PTSD Treatment (77)					SYM 39: From Efficacious to Effective: Interventions for Disadvantaged Couples (100)					SYM 53: Reaching At-risk Populations: Implications for Interventions Aimed at Reducing Sexual Violence, PTSD, Alcohol Use or Their cC-occurrence in Diverse Populations and Settings (125)																				
Aqua 300AB				SYM 3: Understanding the Underlying Mechanisms of Bipolar Disorder: Preliminary Data on Inflammation (25)					MWK 3: Spirituality & Cognitive Behavioral Therapy (50)					MWK 5: Everything You Need to Know About Your Patients' Sex Life, But are Afraid to Ask (74)					MWK 7: Therapist Drift in CBT: Why Well-meaning Clinicians do Dumb Things (and How to do Fewer of Them) (97)					MWK 9: End the Insomnia Struggle: Enhancing Cognitive Behavioral Therapy for Insomnia (CBT-I) Using Acceptance and Commitment Therapy (ACT) (123)																				
Aqua 309				Technology and Behavior Change SIG (26)					Trauma and PTSD SIG (51)					Aging Behavior and Cognitive Therapy SIG (71)					Child Maltreatment & Interpersonal Violence SIG (92)					Native American Issues in Behavior Therapy and Research SIG (117)					Hispanic Issues in Behavior Therapy SIG (139)															
Aqua 310				PD 1: Social Work Training in CBT: The Columbia DBT Training Program (27)					SYM 14: Stepping Out of Our Comfort Zones: Moving Beyond Mental Health Clinics and Delivering Services to Children in Their Natural Environments (52)					SYM 25: New Frontiers in Research on Emotion Regulation in Child Development: Relations to Clinically Relevant Outcomes from Infancy through Adolescence (75)					SYM 38: A New Way Forward? Novel Applications of Exposure-Based Therapy in the Context of Eating Disorders (98)					SYM 52: An Update on Research Investigating the Phenomenology of Hoarding Disorder: Consideration of Core Features and Associated Factors (124)																				
Aqua Terrace Foyer								Internship Meet & Greet (46)										Post Grad Meet & Greet (89)																										
Level 4 - Sapphire Level																																												
Sapphire 400				WK 1: Contextual Behavioral Therapies for Gender and Sexual Minorities (44)									WK 3: Adolescent Behavioral Activation Program (70)									WK 6: When Helping Doesn't Help – Overcoming Therapeutic Resistance with TEAM-CBT (116)																						
Sapphire 410				SYM 5: Cultural Considerations in Context: Working with Latino Youth with Internalizing Disorders (31)					MWK 4: A Winter-break Model of Treating College-age Young Adults with OCD: the Fast Track to Improvement (55)					MWK 6 'What do you mean, think about my thinking?' Making Abstract Concepts Come to Life in CBT for Kids (78)					SYM 40: Underlying Risk Factors of Addictions and Their Implication for Treatment (101)					MWK 10: Targeting Military Trauma with Adaptive Disclosure (126)																				
Sapphire 411				New Attendee Orientation Meeting (21)					Couples Research & Treatment SIG (46)					African Americans in Behavior Therapy SIG (65)					Tic and Impulse Control Disorders SIG (89)					Schizophrenia and Other Serious Mental Illnesses SIG (93)					Clinical Research Methods and Statistics SIG (118)					Obesity and Eating Disorders SIG (141)										
Sapphire A				SYM 6: Acceptance-based Treatments in the Context of Established Evidence-Based Interventions: Differential Effects on Behavior, Quality of life, and Symptoms (32)					RPD 1: Experimental Therapeutics: Diverse Methods for Engaging Mechanisms from Treatment Development to Effectiveness Testing (56)					RPD 2: Evaluation and Delivery of Competency-Based Supervision (80)					MPD 1: Hooray!! I Got Into Grad School (102)					SYM 54: The Forgotten Psychologies – Understanding and treating Perfectionism, Procrastination, and Self-Criticism (127)																				
Sapphire B				SYM 7: Overcoming Barriers to Disseminating EBPs Through Service Delivery in Urban Schools and Primary Care Thomas Power (33)					SYM 16: Toward the Clinical Application of Cognitive Bias Modification: Addressing the Psychometric Properties of Measure (57)					SYM 28: Biomarkers and Mechanisms of Anxiety in Autism: Implications for Assessment and Behavioral Interventions (81)					SYM 41: Empirically Supported Mental Health Care with Transgender and Gender Nonconforming Individuals: Moving Beyond Clinical Expertise (103)					SYM 55: Beyond PTSD: Far-reaching Effects of Exposure-based PTSD Treatment on Common Clinical Complexities (129)					SYM 61: A Randomized Controlled Trial of Written Exposure Therapy for PTSD: Outcomes, Moderators, and Mediators (142)															
Sapphire CDGH								Lifetime Achievement Address (Linehan) (66)										Invited Address 2 (Sue) (90)											CRT 2: Demonstration of Two Psychotherapy Approaches With One Client (117)															

() = Page for Listing in Conference Book
CGR = Clinical Grand Rounds
CRT = Clinical Round Table
MCS = Master Clinician Seminar

MPD = Membership Panel Discussion
PD = Panel Discussions
RPD = Research and Professional Development
S = Symposia

SIG = Special Interest Group
WK = Workshop
MWK = Mini Workshop
1A, 2A, etc... = Poster Sessions

Meeting Room	Time	8 a.m.				9 a.m.				10 a.m.				11 a.m.				12 p.m.				1 p.m.				2 p.m.				3 p.m.				4 p.m.				5 p.m.				6 p.m.		
		:00	:15	:30	:45	:00	:15	:30	:45	:00	:15	:30	:45	:00	:15	:30	:45	:00	:15	:30	:45	:00	:15	:30	:45	:00	:15	:30	:45	:00	:15	:30	:45	:00	:15	:30	:45	:00	:15	:30				
Sapphire EF						SYM 8: Race-Related Stress and Mental Health Outcomes among Black/African Americans: Clinical and Research Considerations (34)						SYM 17: Fighting Mental Illness Stigma: Recent Conceptual and Intervention-Related Advances (58)						SYM 29: Novel Developments on Neurocognitive Interventions: Gaze-contingent Training Techniques to Target Attention Biases in Psychological Disorders (82)						SYM 42: The Role of Trauma-Related Cognitions in PTSD (104)						CGR: Mechanism-Based Treatments of Irritability: Exposure-Based CBT and Interpretation Bias Modification (131)														
Sapphire IJ						SYM 9: Trauma and Posttraumatic Cognitions: Differences Across Diverse Populations (35)						PD 6: If I Knew Then What I Know Now: Best Practices in Ambulatory Assessment of High-risk Populations (59)						SYM 30: Dealing With the Effects of Childhood Adversity Among Adult Primary Care Patients: A Novel Approach to Risk Reduction (83)						SYM 43: OCD in Diverse Contexts: Culture, Race, and Religion (105)						SYM 56: Improving Treatment for Underserved Racial/Ethnic Minority Young Adults with Anxiety Disorders (132)														
Sapphire KL						MWK 1: Using Telemental Health in Diverse Contexts to Overcome Barriers of Access to Care (36)						SYM 18: New Advances in Group CBT: Expanding the Reach and Context of Interventions (60)						SYM 31: Depression and Self-Injurious Thoughts and Behaviors in Young People with ADHD: Identifying Risk Processes and Informing Prevention Efforts (84)						SYM 44: Am I at risk? Factors Predicting the Development and Maintenance of Obsessive Compulsive Related Disorders (106)						SYM 50: Machine Learning Techniques Accurately Predict Suicide Ideation, Attempts, Death: Implications for Theory and Practice (120)														
Sapphire MN						SYM 10: Innovations in the Treatment of Obsessive-Compulsive and Related Disorders (38)						SYM 19: Refining our Understanding of Cognitive Biases in Social Anxiety: New Insights Based on Diverse Methodologies (61)						SYM 32: Introducing Computational Clinical Science: New Techniques to Improve Methods, Theory, Diagnosis, and Prediction (85)						SYM 45: Addressing Mental Health Disparities via Integrated Pediatric Primary Care (107)						PD 11: Breaking Through the Ivory Ceiling: Strategies and Successes for Women in Psychology and the Clinical Sciences (133)														
Sapphire OP						MWK 2: Taking ERP From Treatment Manual to Your Patients: A (Fun) Guide to Application (39)						SYM 20: From Engagement to Treatment: The Role of Culture and Race in the Treatment of Psychosis (62)						SYM 33: Lessons Learned on Behavioral Intervention Technologies (BITS) for Depression and Anxiety in Children, Adolescents, & Adults (86)						MWK 8: Integrating Mind Over Mood (2nd Ed) with Evidence-Based Practice (108)						SYM 51: Culture and Parenting Practices in Latina Mothers of Young Children: Implications for Parent Training Programs (121)														
Sapphire CDGHKLOP																																					6:30 p.m. – 8:30 p.m. Friday Night Welcoming Cocktail Part/SIG Exposition (144)							
Level 5 - Cobalt Level																																												
Cobalt 500						WK 2: The Nuts and Bolts: Practical Strategies and Tools for Effective Implementation of CBT for Child and Adolescent Anxiety Disorders in Diverse Contexts (45)						MCS 3: Acceptance and Change in Couple Therapy: Integrative Behavioral Couple Therapy (69)																										WK 4: Case Formulation and Treatment Planning in Dialectical Behavior Therapy (114)						
Cobalt 501						CRT 1: Enhancing Recovery from PTSD with Co-Occurring Psychosis in Veterans (40)						SYM 21: Learning About My Pain: Demonstrating the Effectiveness of Group Cognitive-Behavioral Therapy and Pain Education for Multiply Disadvantaged Patients (63)						SYM 34: Irritability in Children and Adolescents: Treatment Needs and Mechanisms for Change (87)						SYM 46: The Dissemination of Personalized Evidenced Based Psychotherapy Treatments for High Risk Older Adults (109)						SYM 57: Managing Minority Stress: Cognitive, Affective, and Behavioral Responses to Discrimination Among Sexual Minorities (134)														
Cobalt 502						SYM 11: Therapist Effects: Current Knowledge, Empirical Advances, and Implications (41)						SYM 22: CBT in Older Adults: Treatment Targets and Modified Strategies (64)						SYM 35: The Role of Exploratory Data Mining in Clinical Research: Demonstrating Applications in Self-injurious Thoughts and Behaviors (88)						SYM 47: Bench to Bedside: Understanding Suicide Prevention from Biomarkers to Implementation Science (110)						SYM 58: New Developments in Understanding Cognitive Processing in Anxiety (135)														

() = Page for Listing in Conference Book
CGR = Clinical Grand Rounds
CRT = Clinical Round Table
MCS = Master Clinician Seminar

MPD = Membership Panel Discussion
PD = Panel Discussions
RPD = Research and Professional Development
S = Symposia

SIG = Special Interest Group
WK = Workshop
MWK = Mini Workshop
1A, 2A, etc... = Poster Sessions

Meeting Room	Time	8 a.m.				9 a.m.				10 a.m.				11 a.m.				12 p.m.				1 p.m.				2 p.m.				3 p.m.				4 p.m.				5 p.m.				6 p.m.						
		:00	:15	:30	:45	:00	:15	:30	:45	:00	:15	:30	:45	:00	:15	:30	:45	:00	:15	:30	:45	:00	:15	:30	:45	:00	:15	:30	:45	:00	:15	:30	:45	:00	:15	:30	:45	:00	:15	:30	:45	:00	:15	:30	:45			
Level 2 - Indigo Level																																																
Indigo 202	WK 7: Individual and Group Cognitive-Behavioral Therapy For Diverse Addictive Behaviors (146)																WK 10: Trauma Informed Guilt Reduction (TriGR): A Transdiagnostic Cognitive Behavioral Therapy for Posttraumatic Distress (189)								WK 12: Tricking Coyote: Cutting-Edge Strategies for Harnessing Motivation (235)																							
Indigo 204	WK 8: Applying CBT in the Digital Age: E-mental Health Resources and Skills for Practitioners (147)																WK 11: Developing and Deepening Your Experiential Practice in Acceptance and Commitment Therapy (190)								WK 13: Culturally Adapting Psychotherapy for Diverse Populations: An Evidence-based Approach (236)																							
Indigo 206	Clinical Psychology at Liberal Arts Colleges SIG (149)								Behavioral Sleep Medicine SIG (169)								Military Psychology SIG (196)								Sexual and Gender Minority SIG (217)								Neurocognitive Therapies / Translational Research SIG (258)															
Indigo A	SYM 62: Romantic Relationship Functioning and Well-being Among Sexual Minority Youth, Adults, and Couples: Methodological and Scientific Advances (150)								CRT 5: Do All Roads Lead to Rome? Examining the Treatment of OCD from Different Theoretical Perspectives (167)								PD 16: Dialectical Behavior Therapy in College Counseling Centers (191)								CRT 8: Applying Dialectical Behavior Therapy to the Treatment of Emotion Dysregulation in Gender Diverse People (213)								CRT 9: The Traumatized, Suicidal Adolescent: Treatment Considerations in the Application of DBT-A and PE-A (234)								PD 22: Exploring the Intersection of Policy, Practice and Research Adapting an Evidence-based Ecological Intervention in an International Context (256)							
Indigo B	SYM 63: Aftercare Engagement across Diverse Contexts: Identifying Vulnerable Consumers and Effective Intervention (151)								SYM 72: Emotional Reactivity and Regulation in Borderline Personality Disorder: Illuminating Patterns Across Diverse Contexts and Samples (170)								SYM 82: Mechanisms of Risk for Intergenerational Transmission of Anxiety and Depression: Triangulating Research across Multimodal Methodologies (197)								SYM 94: Behavioral Interventions for Pediatric Health Conditions: Results from Prospective Studies (217)								SYM 105: Brief Behavioral Therapy (BBT) for Anxiety and Depression in Pediatric Primary Care: Predictors, Moderators, and Results on Associated Outcomes (242)															
Indigo CDGH	Exhibits & Poster Sessions																				Exhibits & Poster Sessions																											
	Poster Session 8 8:30 - 9:30				Poster Session 9 9:45 - 10:45				Poster Session 10 11:00 - 12:00				Poster Session 11 12:15 - 1:15				Poster Session 12 1:30 - 2:30				Poster Session 13 2:45 - 3:45				Poster Session 14 4:00 - 5:00																							
	8A - Couples/ Close Relationships (382)				9A - Adult Anxiety- GAD Adult Anxiety- SOC (391)				10A - Adult Anxiety- Social Adult Anxiety- GAD (401)				11A - OCD Schizophrenia Translational Other- Not Fitting (412)				12A - Eating Disorders (422)				13A - Suicide and Self Injury (432)				14A - Adult Depression/ Dysthmic Child/ Adolescent Depression (442)																							
	8B - Treatment Mindfulness Treatment ACT (385)				9B - Criminal Justice/ Forensics Technology Professional Issues Education/ Training/ Supervision (394)				10B - Parenting/ Families Child/ Adolescent- School Related Issues (404)				11B - Child/ Adolescent Anxiety (415)				12B - Child/ Adolescent Anxiety (425)				13B - Neuroscience Cognitive Science Research Methods + Statistics (436)				14B - Couples/ Close Relationships Sexual Functioning (445)																							
	8C - Aging/ Older Adults Spirituality and Religion Cultural Diversity/ Vulnerable Populations (388)				9C - Parenting/ Families (398)				10C - Health Psychology/ Bx Medicine- Adult Health Psychology/ Bx Medicine- Child (408)				11C - Child/ Adolescent Externalizing Violence/ Aggression (419)				12C - Tx DBT Personality Disorders (429)				13C - PTSD Trauma + Stressor Related Disorders Child/ Adolescent Trauma/ Maltreatment (439)				14C - Women's Issues/ Gender LGBT Cultural Diversity/ Vulnerable Populations (449)																							
Indigo E	SYM 64: New Advances in the Treatment of Hoarding Disorder (152)								SYM 73: Adaptations of Cognitive Behavioral Treatment for Diverse Groups Living with or at Risk for HIV (171)								SYM 83: Data-driven Approaches to Exploring Heterogeneity in Response to Treatments for Mood and Anxiety Disorders (198)								SYM 95: Maximizing Telephone- and Web-based Interventions for Couples and Families (219)								SYM 106: Self-Harm Behavior Does Not Discriminate: NSSI and Suicide Across Diverse Populations (243)															
Level 3 - Aqua Level																																																
Aqua (Salon) AB	SIG Leaders Meeting (145)								SYM 70: Applying Cognitive Behavioral Therapy in Low and Middle Income countries: Trials, Advances, and Implementation Strategies (166)								SYM 81: Self -Stigma among People with Serious Mental Illness: Health, Sense of Belonging, and Proactive Coping (188)								SYM 92: Can We Assess Suicide Without Asking About It?: The Latest Research on Implicit Markers of Suicidal Ideation, Behavior, and Risk (212)								SYM 104: Putting the Positive into Social Anxiety Disorder: Towards a More Complete Understanding of SAD to Optimize Treatment Efficacy and Effectiveness (233)								SYM 113: What Influences Therapist Delivery of Child Evidence-Based Interventions in Community Mental Health Settings? An Examination of Therapist Background, Attitudes, and Session Process Characteristics (257)							

() = Page for Listing in Conference Book
CGR = Clinical Grand Rounds
CRT = Clinical Round Table
MCS = Master Clinician Seminar

MPD = Membership Panel Discussion
PD = Panel Discussions
RPD = Research and Professional Development
S = Symposia

SIG = Special Interest Group
WK = Workshop
MWK = Mini Workshop
1A, 2A, etc... = Poster Sessions

Meeting Room	8 a.m.				9 a.m.				10 a.m.				11 a.m.				12 p.m.				1 p.m.				2 p.m.				3 p.m.				4 p.m.				5 p.m.				6 p.m.										
	:00	:15	:30	:45	:00	:15	:30	:45	:00	:15	:30	:45	:00	:15	:30	:45	:00	:15	:30	:45	:00	:15	:30	:45	:00	:15	:30	:45	:00	:15	:30	:45	:00	:15	:30	:45	:00	:15	:30	:45	:00	:15	:30	:45							
Aqua (Salon) C & D					SYM 65: Mechanism-Based Approach to Targeted Provider Training for Improving Quality and Outcomes of Exposure Therapy (155)				SYM 74: An Invisible and Under-represented Health Disparity Population: Advances in Research on Stigma and Mental Health Among Bisexual Individuals (174)				SYM 84: Neurocognitive Mechanisms of Worry and Rumination (200)				SYM 96: Treatment of Families of Children with ADHD Across Diverse Contexts. (221)				SYM 107: From Global to Local: Assessment and Treatment of Culturally Diverse Trauma-exposed Groups in Low-Resource Settings (245)																														
Aqua (Salon) E & F					PD 12: Tales from the Frontlines of Primary Care Behavioral Health: Practical Concerns and Pragmatic Advice in Applying CBT in Primary Care Settings. (156)				SYM 75: Moving Science from the Clinic to the Community: Designing and Testing CBT interventions in Community Agencies. (175)				SYM 85: Understanding the Role of Diversity in Treatment Response to Rehabilitative Approaches in Schizophrenia: Who Responds Best to What and Why? (201)				SYM 97: How Can Ecological Momentary Assessment Help Us Understand Mood and Anxiety Pathology Better?: Capturing Daily Emotional Experiences. (222)				SYM 108: Innovations in CBT for Active Duty Military Personnel. (246)																														
Aqua 300AB					MWK 11: Cultural Competence Matters: Clinical Adaptations to Effectively Address Race-Based Stress in Black Clients (153)				MWK 13: Delivering Culturally Competent Behavioral Couple Therapy when Working with Same-Sex Couples (172)				MWK 15: Behavioral Couples Therapy for Substance Use Disorders (199)				MWK 16: Psychological Services in Forensic & Correctional Settings: Treatment, Safety, & Ethical Issues (220)				MWK 18: Exposure-based Treatment for Eating Disorders: Addressing Anxiety on Both Sides of the Table (244)																														
Aqua 309					Suicide and Self-Injury SIG (154)				Bipolar Disorders SIG (173)				Child and Adolescent Depression SIG (194)				Functional Analytic Psychotherapy SIG (214)				Child and School-Related Issues SIG (235)				Mindfulness & Acceptance SIG (257)																										
Aqua 310					Dissemination and Implementation Science SIG (154)				Attention-Deficit/Hyperactivity Disorder SIG (173)				Asian American Issues in Behavior Therapy and Research SIG (199)				Student SIG (215)				Directors of Clinical Training Meeting (240)																														
Level 4 - Sapphire Level																																																			
Sapphire 400					MCS 6: Assertive Defense of the Self: CBT for Social Anxiety (145)				MCS 7: An Interactive Demonstration of the Unified Protocol for the Treatment of Emotional Disorders in Children (UP-C) (186)												WK 14: Beyond Panic: Applying Interoceptive Exposure across the Anxiety-Related Conditions and Life Span (237)																														
Sapphire 410					CRT 3: Reducing the Cognitive Load of Cognitive-Behavioral Therapy: The Process of Adapting and Implementing CBT in a Low Literacy Chronic Pain Population (157)				MWK 14: Teaching and Disseminating Behavioral Medicine Principles to Primary Care Physicians & Allied Health Professionals (176)				MPD 2: If I Knew Then What I Know Now: Wisdom Learned on Developing a Career as a Cognitive Behavioral Therapist (202)				MWK 17: Implementation of Cognitive Behavioral Therapy with Children and Adolescents in School Settings (223)				MWK 19: Recovery-oriented Cognitive Therapy for Schizophrenia: An Evidence-based Program for Individuals with Schizophrenia, in and out of the Hospital (247)																														
Sapphire 411					Parenting & Families SIG (158)				Behavior Analysis SIG (177)				Forensic Issues and Externalizing Behaviors SIG (203)				Addictive Behaviors SIG (224)				Behavioral Medicine and Integrated Primary Care SIG (248)																														
Sapphire A					SYM 66: Cognitive control, IQ, and inattention in Obsessive-Compulsive Disorder (158)				CRT 6: Exploring the Fullness of Time: Delivering Effective Mindfulness- and Acceptance-Based Interventions and Programs for Older Adults (178)				SYM 86: Beyond Diagnosis: Mediators Underlying the Link Between PTSD and Adverse Outcomes (203)				SYM 98: New Frontiers in Cognitive Training and Cognitive Bias Modification (224)				SYM 109: The Rising Tide of Evidence-based Mental Health Service Delivery: Implementation Strategies to Get School Professionals Into the Boat (249)																														
Sapphire B					RPD 3: Strategies for Providing Effective Training in CBT with Diverse Populations (159)				SYM 76: Common and Specific Predictors of Depression and Anxiety Across Diverse Settings (179)				SYM 87: Novel Targets and Change Mechanisms in Preventio (204)n				SYM 99: Novel Treatment Approaches to Increase Access to Parent Mediated Interventions for Families of Children with Autism Spectrum Disorder (225)				PD 20: Treating Obsessive-Compulsive Spectrum Disorders in Diverse Contexts and Populations (250)																														
Sapphire CDGH													Invited Address 2 (Safren) (195)				Invited Address 3 (Miranda) (216)								PRESIDENTIAL ADDRESS (259)																										
Sapphire EF					PD 13: Shortening the Science-to-Service Pipeline: Forming a Tighter Link Between Neuroscience and Implementation Science (160)				SYM 71: Supporting Clinicians to Deliver Cognitive Behavioral Therapy Across Routine Clinical Settings: Insights from Implementation Science (168)				RPD 5: What is implementation science and why is it relevant to you? (192)				SYM 93: Moving Beyond Heteronormative Monogamy: Examining Diversity in Romantic Relationships and Commitment Structures (214)				RPD 6: Using Data to Plug the "Leaky Pipeline:" Empirically-Supported Approaches for Promoting Gender Equity in the Academy (239)				PD 23: Process-based CBT (258)																										

() = Page for Listing in Conference Book
CGR = Clinical Grand Rounds
CRT = Clinical Round Table
MCS = Master Clinician Seminar

MPD = Membership Panel Discussion
PD = Panel Discussions
RPD = Research and Professional Development
S = Symposia

SIG = Special Interest Group
WK = Workshop
MWK = Mini Workshop
1A, 2A, etc... = Poster Sessions

Meeting Room	8 a.m.				9 a.m.				10 a.m.				11 a.m.				12 p.m.			
	:00	:15	:30	:45	:00	:15	:30	:45	:00	:15	:30	:45	:00	:15	:30	:45	:00	:15	:30	:45
Level 2 - Indigo Level																				
Indigo 202					RPD 7: Careers in Clinical Psychology: Which Path Makes Sense For Me? (262)								SYM 132: Understanding Issues of Engagement in CBT Among Hard-to-reach Populations Using Culturally Informed Approaches (287)							
Indigo 204					SYM 115: Spotlight on the Glass Ceiling: A Presentation of Gender Disparities with Implications for the Future of our Field (263)								CRT 14: Strategies for Successful Implementation of Measurement-Based Care Implementation Across Diverse Contexts (288)							
Indigo A					SYM 116: Mechanisms of change in mindfulness-based interventions (264)								SYM 133: Evaluating Prominent Theories Concerning the Role of Stress in Anxiety and Depression Trajectories (289)							
Indigo B					SYM 114: Issues Involving Special Populations in Hoarding Disorder (261)								SYM 131: Expanding the AS Horizon: Recent Advances in the Study of Anxiety Sensitivity among Individuals with Medical Conditions (286)							
Indigo CDGH	Exhibits & Poster Sessions																			
					Poster Session 15 9:00 - 10:00 AM															
					15A - Addictive Bx (453)															
					15B - Adult Anxiety Adult Anxiety Panic Adult Anxiety Phobias Comorbid- Anxiety and Other (456)															
					15C - PTSD (459)															
Indigo E					CRT 11: Couple Therapy and Research, Plus or Minus Forty: A Brief Look Back, A Major Look Forward (265)								SYM 134: Meeting People Where They are: Innovative Strategies for Expanding Access to CBT (290)							
Level 3 - Aqua Level																				
Aqua (Salon) AB					SYM 118: Transdiagnostic examination of the impact of DBT skills and strategies on emotion regulation (268)								PD 27: Supporting Implementation of Evidence-Based Practices in School and Community Settings (292)							
Aqua (Salon) C & D													SYM 135: Disseminating Motivational Interviewing in Diverse Settings: Lessons Learned from Research and Practice (293)							
Aqua (Salon) E & F					SYM 120: The Dissemination of CBT to Diverse Contexts: National Utilization Patterns, Adoption Versus Proper Implementation, and Scalable Training for Graduate and Post-graduate Therapists (269)								SYM 136: Developing, Refining, and Implementing Text-Message Interventions for At-Risk Populations (294)							
Aqua 300AB					SYM 117: Cutting-Edge Longitudinal Models for CBT Research (266)															
Aqua 309					Oppression and Resilience: Minority Mental Health SIG (266)															
Aqua 310					RPD 8: Training the Next Generation in Measurement-Based Care: Implementation & Training of Routine Outcome Monitoring in Training Clinics (267)								Men's Mental & Physical Health SIG (291)							

() = Page for Listing in Conference Book
CGR = Clinical Grand Rounds
CRT = Clinical Round Table
MCS = Master Clinician Seminar

MPD = Membership Panel Discussion
PD = Panel Discussions
RPD = Research and Professional Development
S = Symposia

SIG = Special Interest Group
WK = Workshop
MWK = Mini Workshop
1A, 2A, etc... = Poster Sessions

Meeting Room	8 a.m.				9 a.m.				10 a.m.				11 a.m.				12 p.m.			
	:00	:15	:30	:45	:00	:15	:30	:45	:00	:15	:30	:45	:00	:15	:30	:45	:00	:15	:30	:45
Level 4 - Sapphire Level																				
Sapphire 400					SYM 121: Alternative Classification Systems Within Eating Disorders: Insights from Innovative Methodological Investigations (270)								SYM 137: Evaluating Individual Emotional Skillfulness in Relationship Health (295)							
Sapphire 410					SYM 122: Assessing and Modeling Stress Processes in Suicide and Depression (272)								CRT 13: Applications of the Unified Protocol: Implementing Transdiagnostic Strategies for Complex and Highly Comorbid Clinical Cases (296)							
Sapphire 411					CRT 12: Using Evidence-Based Practices with Specific Religious and Non-Religious Populations (273)															
Sapphire A					SYM 123: Designing and Disseminating Large-scale Interventions for Anxiety in Youth (274)								SYM 138: Novel Extensions for Interventions Targeting Transdiagnostic Risk Factors for Anxiety and Related Psychopathology (297)							
Sapphire B					SYM 124: Indications for Adaptations to Evidence-Based Practices in Community Mental Health (275)								RPD 9: Models for Training Clinical Scientists (298)							
Sapphire CD					PD 25: Prevent or permit? The issue of safety behavior use during exposure therapy for anxiety. (276)								SYM 139: Sensory Features of Obsessive-Compulsive Related Disorders: A Dimensional Perspective from Community to Clinical Populations. (299)							
Sapphire EF					SYM 125: Utilizing Technology-Based Interventions to Increase Access to Evidence-Based Treatments for Internalizing Disorders Across Diverse Populations and Settings (277)															
Sapphire IJ					SYM 126: Novel Strategies for Preventing Relapse for Anxiety-Related Disorders: Advances from Translational Research (278)								SYM 140: Forensic Assessment: Applying Evidence-Based Principles to Diverse Settings and Populations (300)							
Sapphire KL					SYM 127: Applying CBT in Diverse Contexts: LGBTQ+ treatment outcomes (279)								PD 28: How Do we Effectively Improve Engagement in Evidence-based Therapies for Individuals From Diverse Backgrounds? Suggested Strategies, Current Efforts, and How to Move Forward (301)							
Sapphire MN					SYM 128: Factors Influencing Engagement with Evidence Based Psychotherapies for PTSD in Diverse Patient Populations (280)								SYM 141: The utility of Network Analysis for Cognitive-Behavior Therapy: Clinical Integration (302)							
Sapphire OP					PD 26: Considering the 'Modern Family': Multicultural Identities in Family-based CBT (282)								SYM 142: Using Computers, Internet, and Mobile Applications to Treat Anxiety: A Mechanisms Approach (303)							
Level 5 - Cobalt Level																				
Cobalt 500					PD 24: Pediatric Primary Care opportunities for implementing behavioral and cognitive therapy interventions and consultations. (283)								SYM 143: Diversity of Response to Trauma and to Trauma-Focused Treatment. (304)							
Cobalt 501					SYM 129: How Do We Take Measurement-based Care to the Next Level? Understanding Barriers and Facilitators to Implementing Measurement-based Care in Diverse Settings (284)								SYM 144: Where Do We Start? Early Intervention and Treatment for Young Children with ADHD Across Diverse Contexts (305)							
Cobalt 502					SYM 130: Family Interactions and Expressed Emotion across the Lifespan and Across a Spectrum of Psychopathology (285)															

Level 1 | Promenade Level

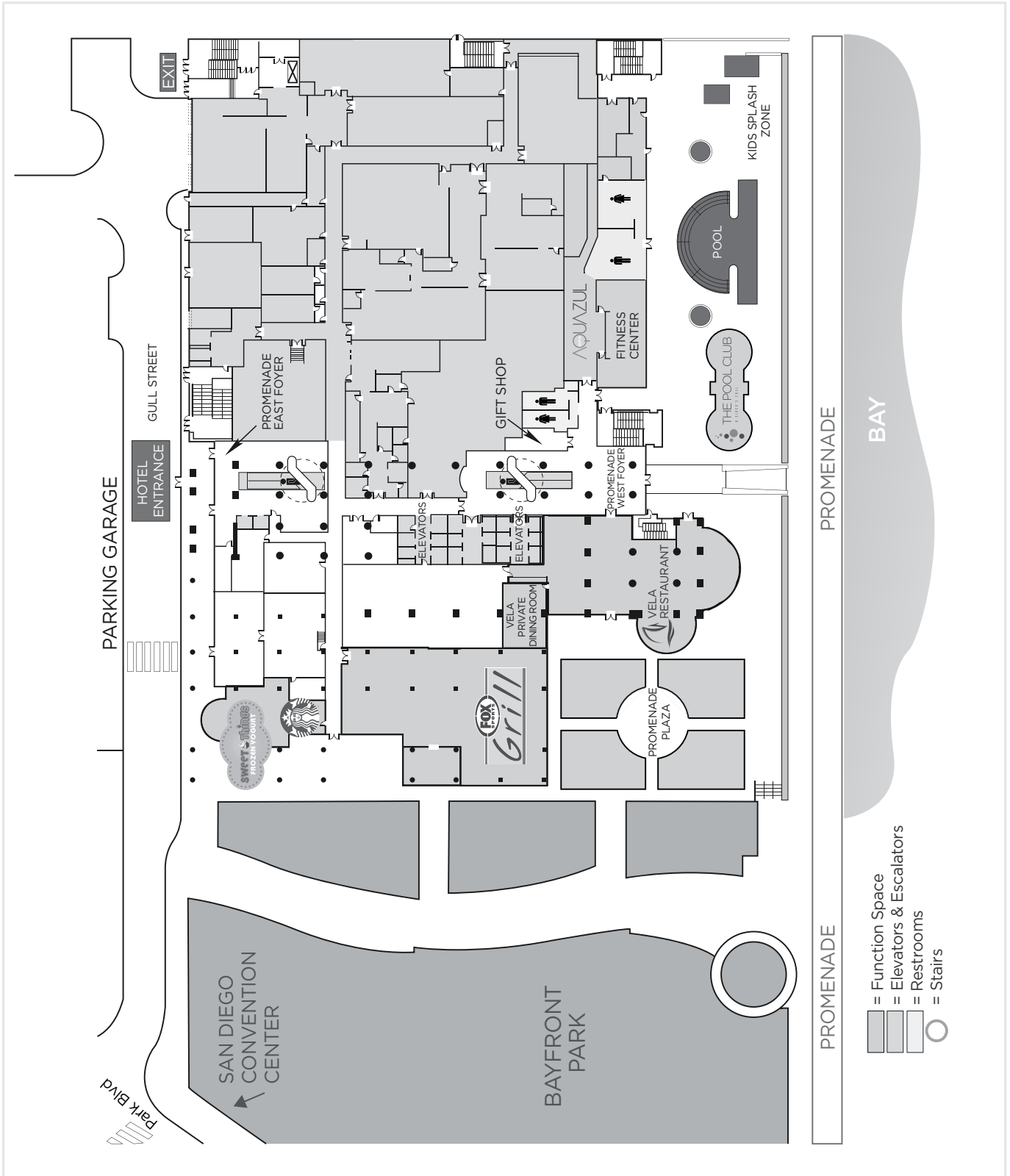

Level 2 | Indigo Level

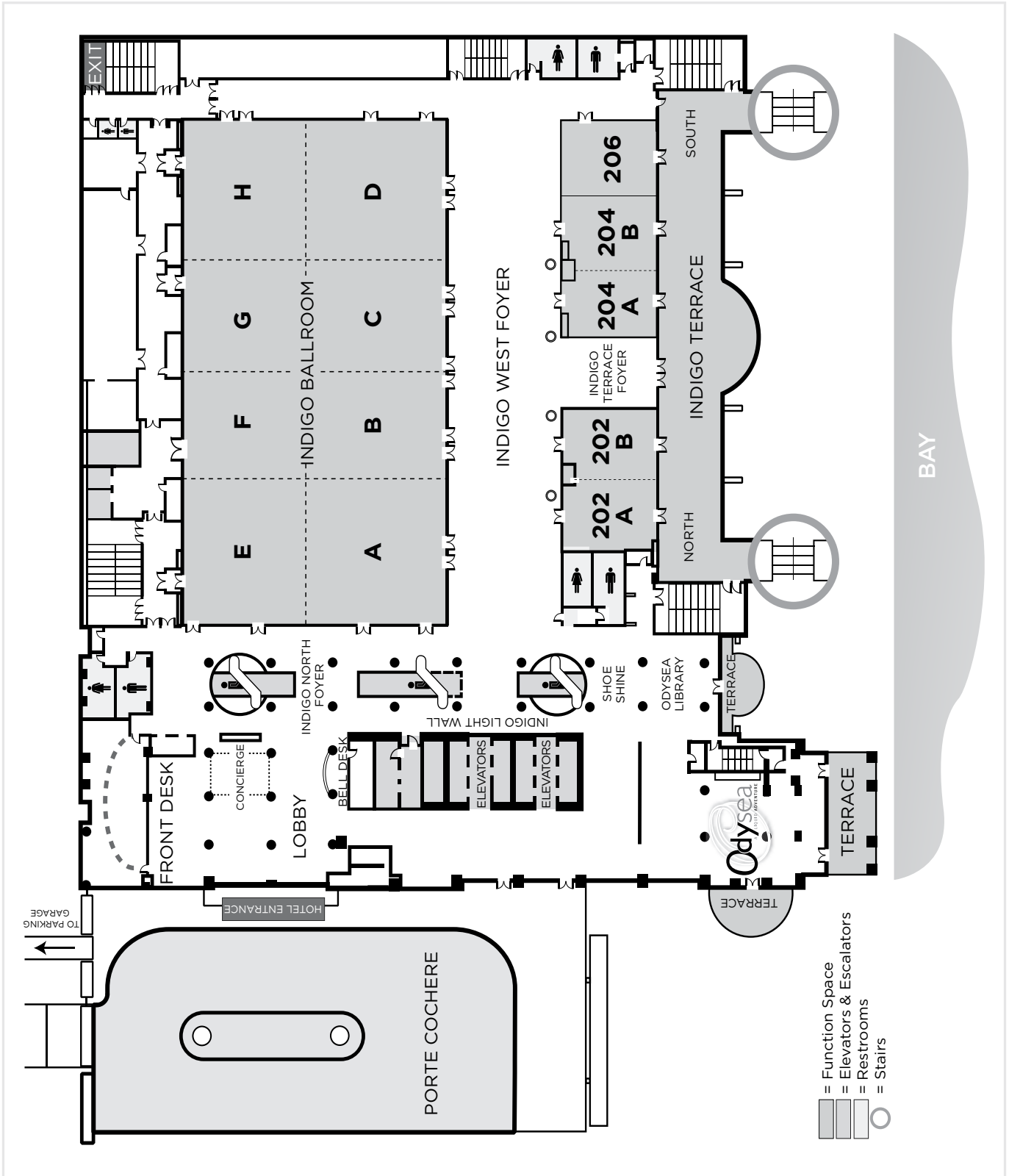

Level 3 | Aqua Level

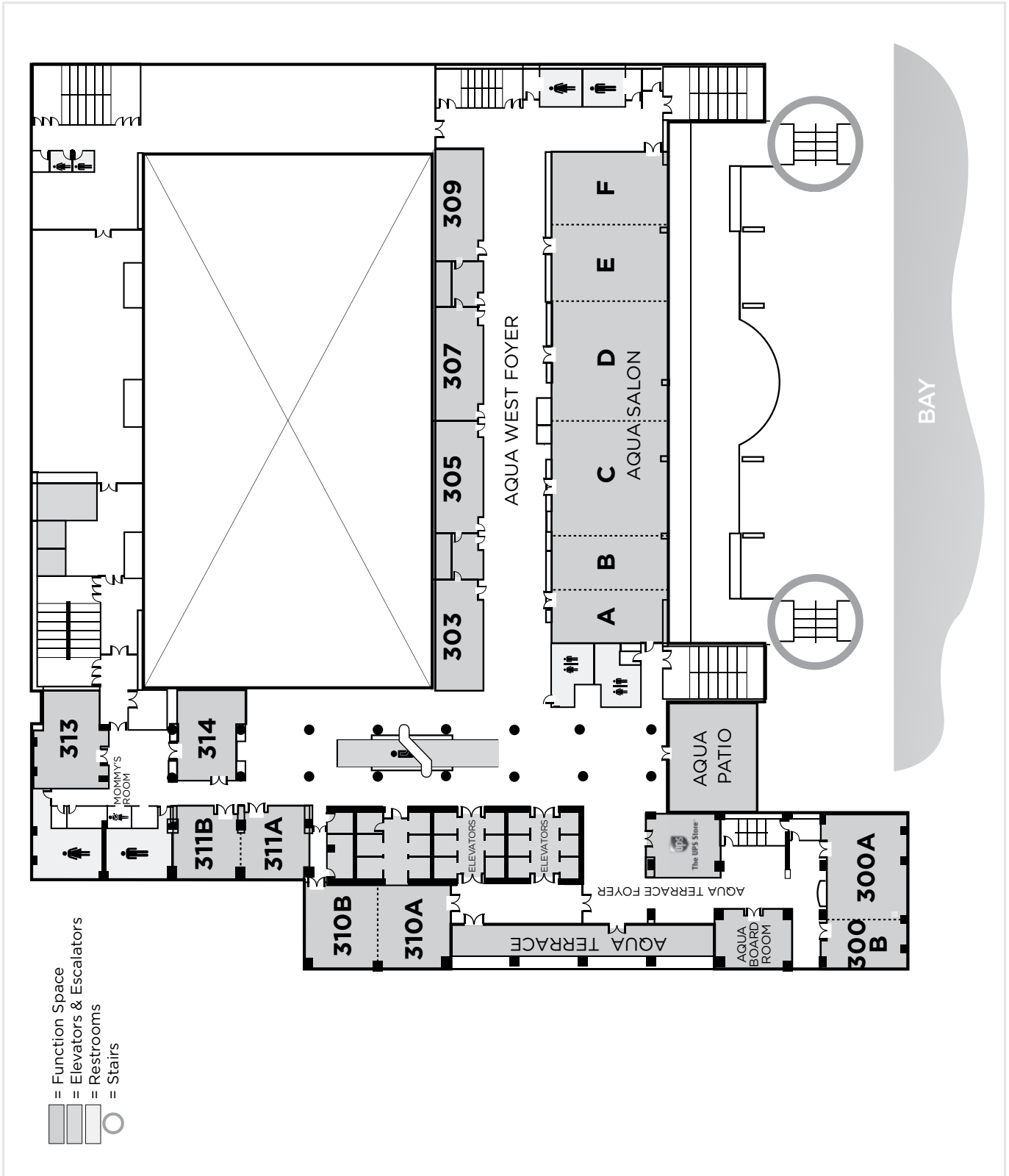

Level 4 | Sapphire Level

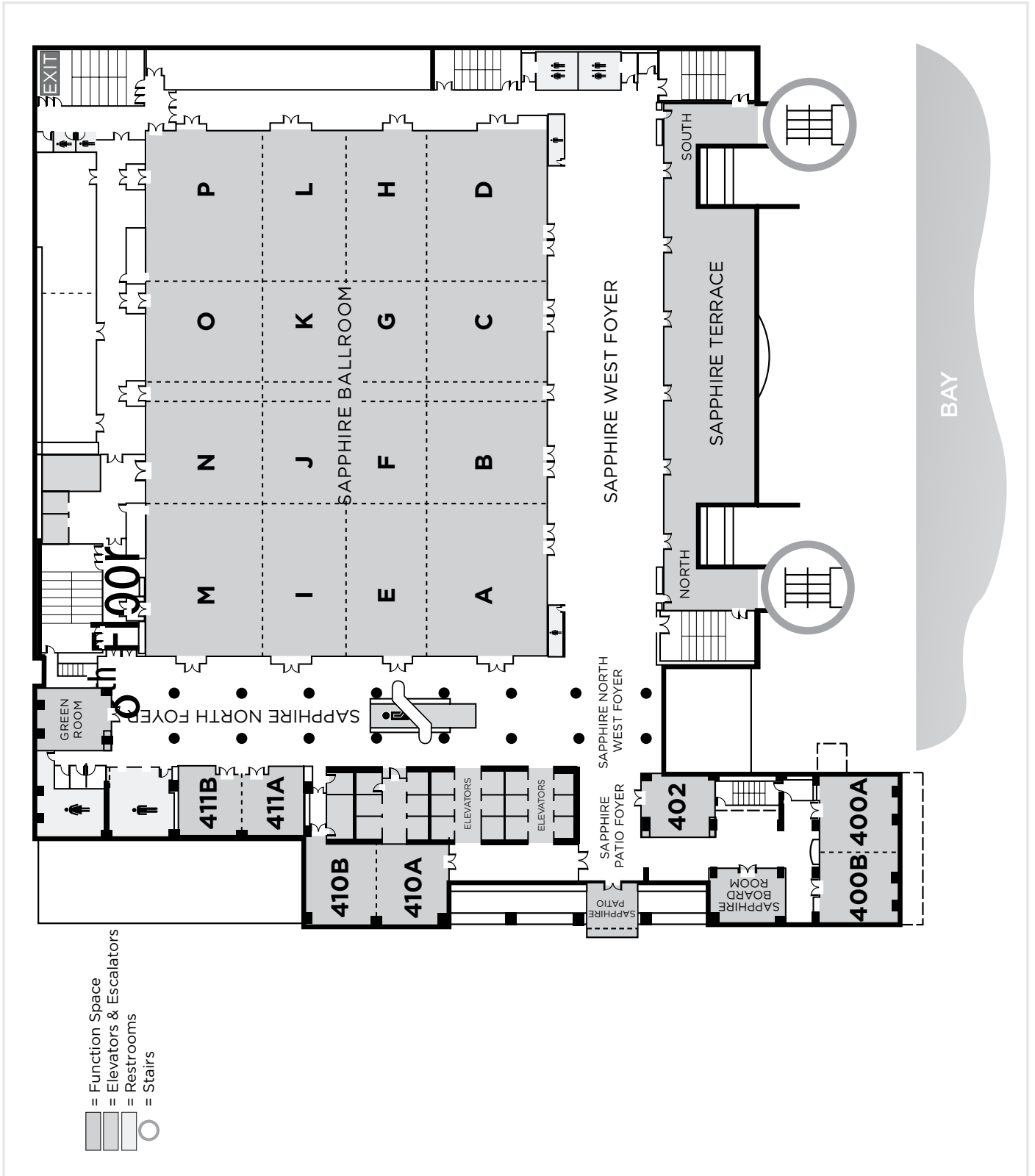

Level 5 | Cobalt Level

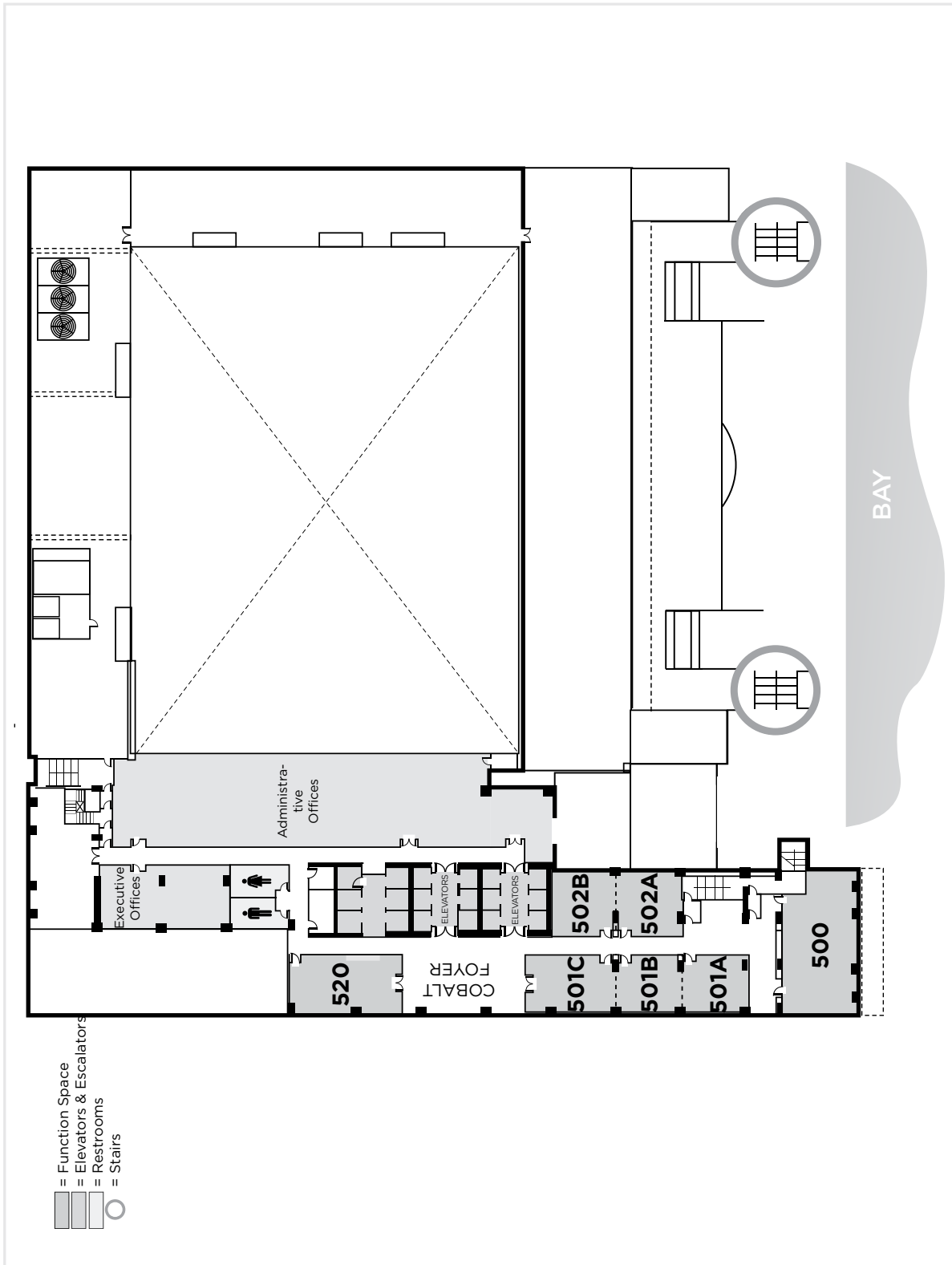

www.abct.org

